



SERVO-DRIVE uno

for bottom mount waste bin solutions

Technical data sheet

SERVO-DRIVE uno

Order specification

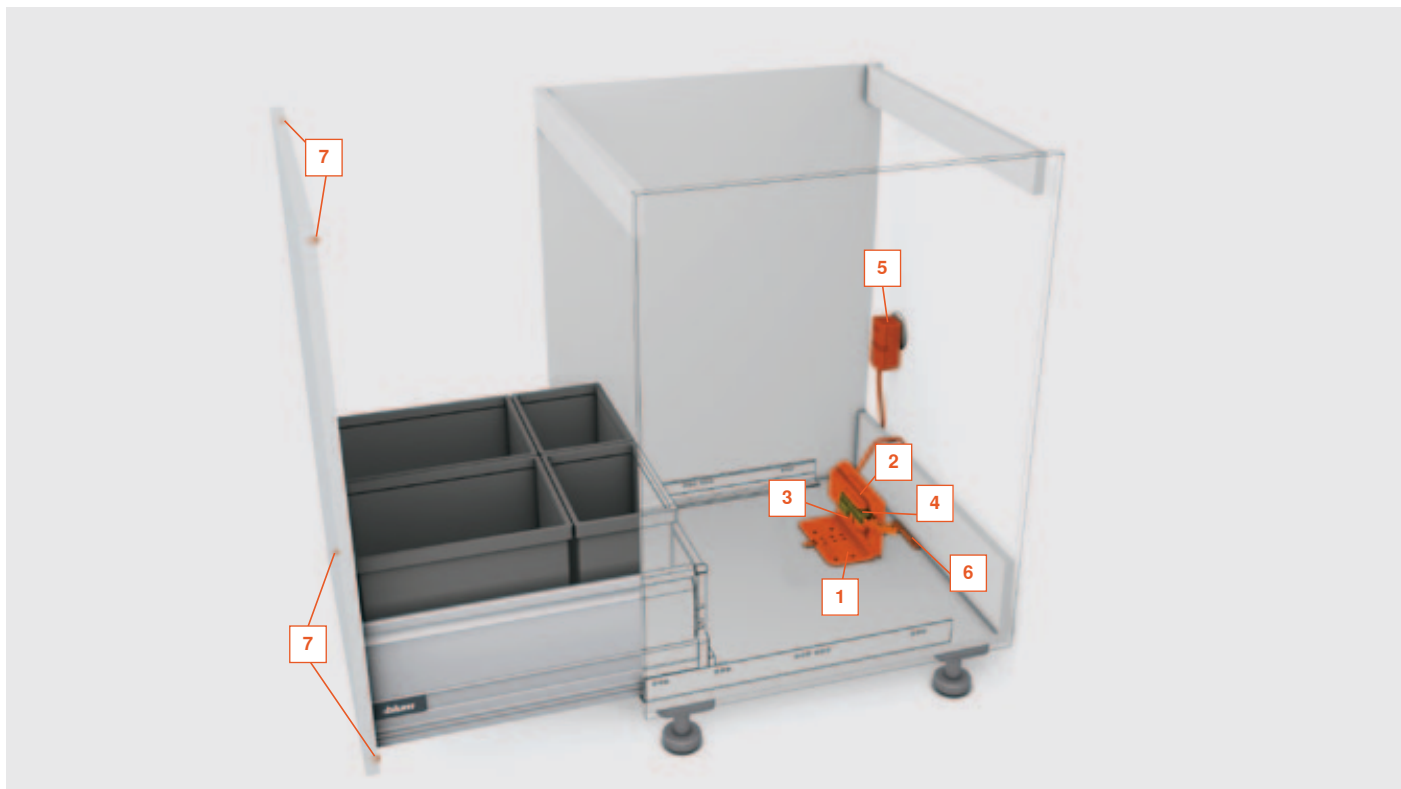

SERVO-DRIVE uno assists you to get rid of waste quickly and easily. When your hands are full of kitchen waste, it is extremely practical to be able to open the waste bin pull-out with your hip, knee or foot.

Everything in one set



This set contains all SERVO-DRIVE uno components required to equip a waste bin pull-out with SERVO-DRIVE uno (including installation instructions). Set contents are customised for specific countries.

SERVO-DRIVE unit pre-mounted						
	Network adapter (x)			Language package (y)		
	E	B	K	R	A	DE, EN, FR, IT, NL
					B	DA, EN, FI, NO, SV
					C	EN, EL, HR, SR, SL, TR
					D	EN, FR, IT, PT, ES
					E	PL, SK, CS, HU
	N	U	A		F	BG, ET, LV, LT, RO, RU
				G	EN, FR, ES	
				H	ZH, EN	
				Z10NA20xy01		

Composed of:	
1	Attachment bracket
2	Protection against dripping water
3	Drive unit
4	Transport protection
5	Blum power supply
	Instruction leaflet and spare parts form

SERVO-DRIVE uno

Order specification

6	Blum assembly device (optional)	7	Blum distance bumper						
	Self-adhesive, for positioning the SERVO-DRIVE drive unit Without pre-drilling								
	1 pce. Z10D0319		<table><tr><td>Ø 5 mm</td><td>4x</td><td>993.0530</td></tr><tr><td>Ø 8 mm</td><td>4x</td><td>993.0830.01</td></tr></table>	Ø 5 mm	4x	993.0530	Ø 8 mm	4x	993.0830.01
Ø 5 mm	4x	993.0530							
Ø 8 mm	4x	993.0830.01							
			Use 2 pcs. up to front height 300 mm Use 4 pcs. for front heights 300 mm and higher						

SERVO-DRIVE uno

Planning information TANDEMBOX / LEGRABOX

Assembly with position drillings

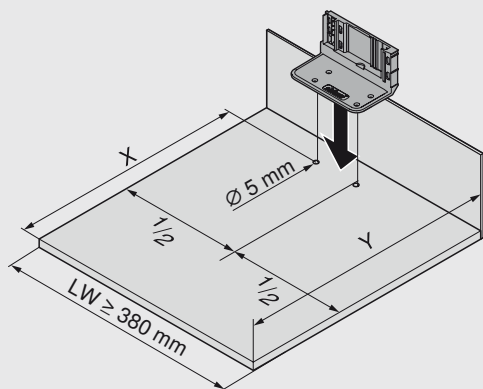

- LT Internal cabinet depth
- NL Nominal Length
- X Drilling position
- Y Min. space requirement

Space requirement and drilling position for all applications

Back	X (mm)	Y (mm)
Steel back	NL - 62	Min. LT = NL + 18
Chipboard back	NL - 45	Min. LT = NL + 35

Front assembly – Position of Blum distance bumper

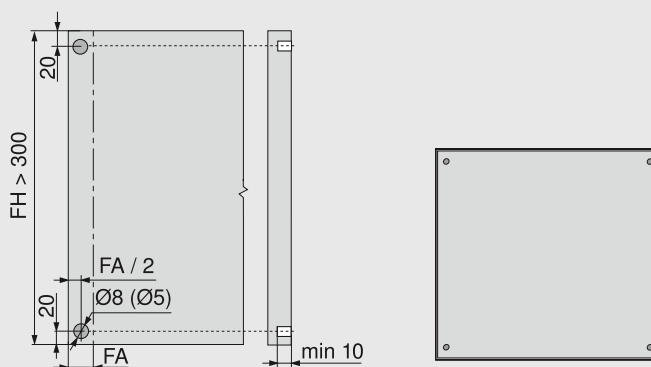

The Blum distance bumper creates and maintains the required trigger path of 2 mm.

- FA Front overlay
- FH Front height

Drive unit position TANDEMBOX

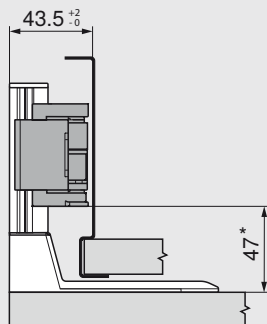

* min 27.5 mm

Fixing position of cabinet profile TANDEMBOX

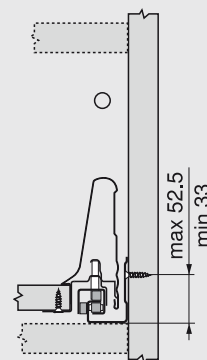

Drive unit position LEGRABOX

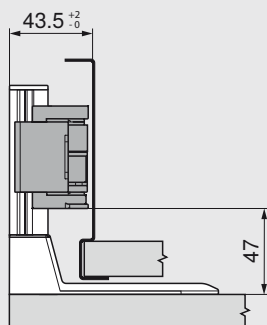

Fixing position of cabinet profile LEGRABOX

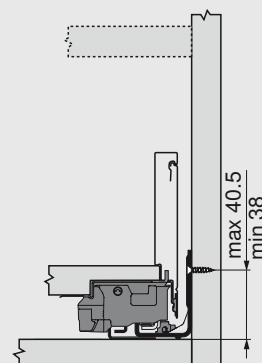

SERVO-DRIVE uno

Planning information MOVENTO / TANDEM

Assembly with position drillings

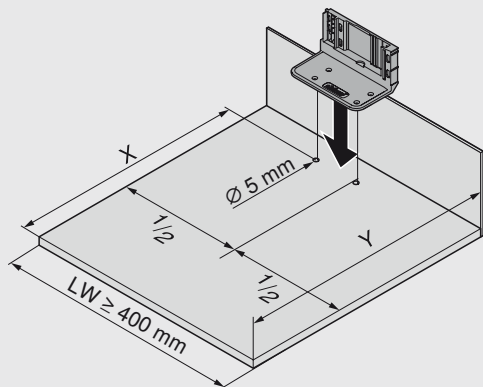

LT Internal cabinet depth

NL Nominal Length

X Drilling position

Y Min. space requirement

Space requirement and drilling position for all applications

Back	X (mm)	Y (mm)
Chipboard back	NL - 48	Min. LT = NL + 32

Front assembly – Position of Blum distance bumper

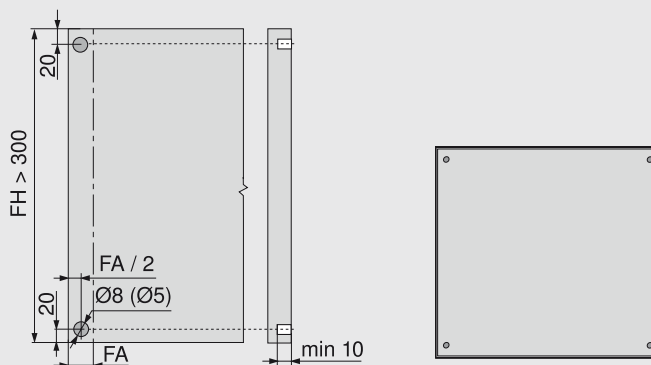

The Blum distance bumper creates and maintains the required trigger path of 2 mm.

FA Front overlay

FH Front height

Drive unit position MOVENTO

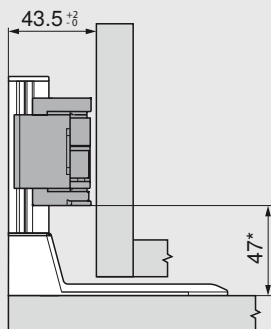

* min 27.5 mm

Fixing position of cabinet profile MOVENTO

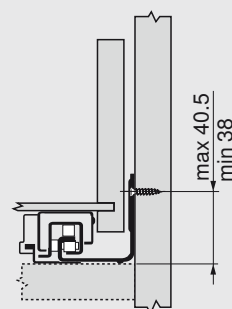

Drive unit position TANDEM

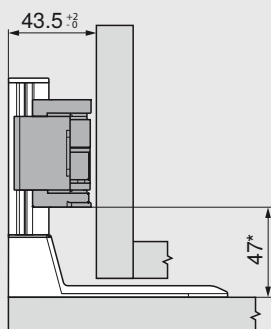

* min 27.5 mm

Fixing position of cabinet profile TANDEM

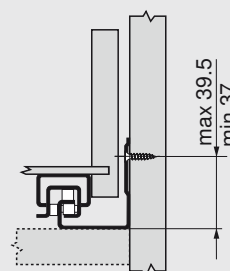

SERVO-DRIVE uno

Assembly

Assembly with position drillings

Attaching the Blum distance bumper

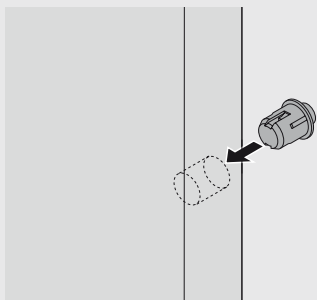

Insert the Blum distance bumper (do not glue)

Screw on attachment bracket

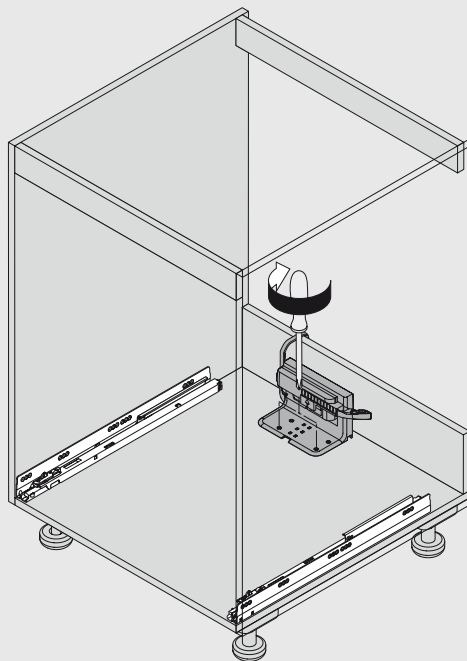

Remove the transportation lock, insert the transformer

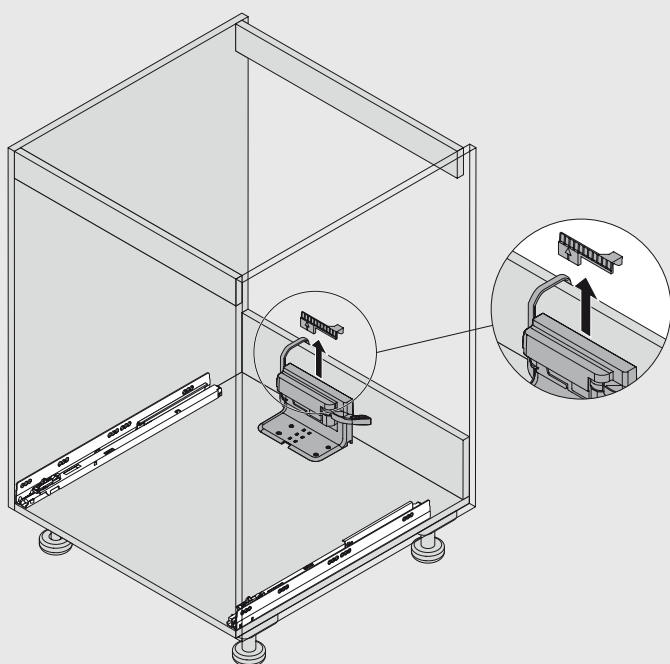

Close high fronted pull-out

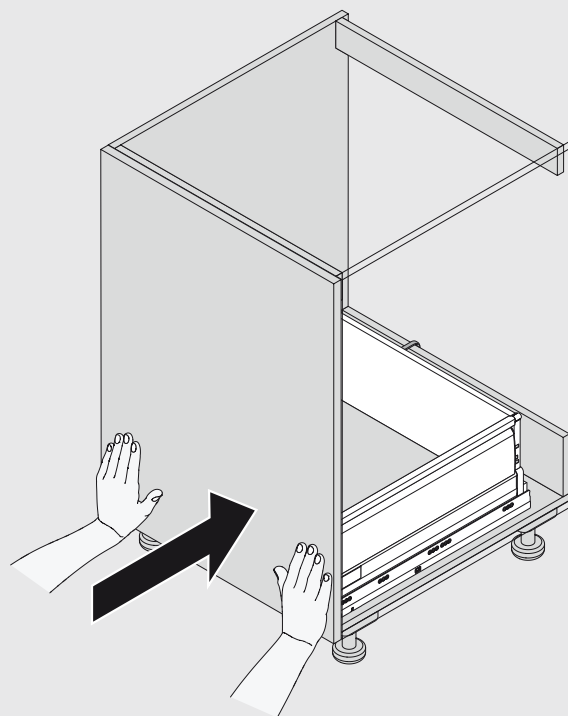

SERVO-DRIVE uno

Assembly

Alternative: Assembly with assembly device

Attaching the distance bumper

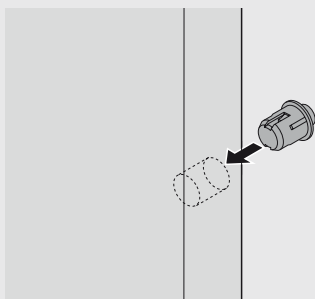

Insert the Blum distance bumper (do not glue)

Place assembly device on cabinet base

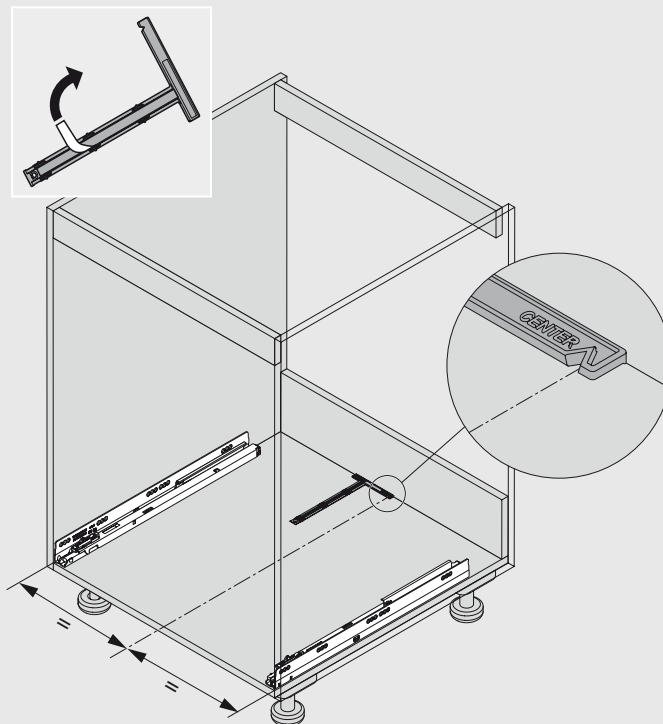

Place attachment bracket on assembly device

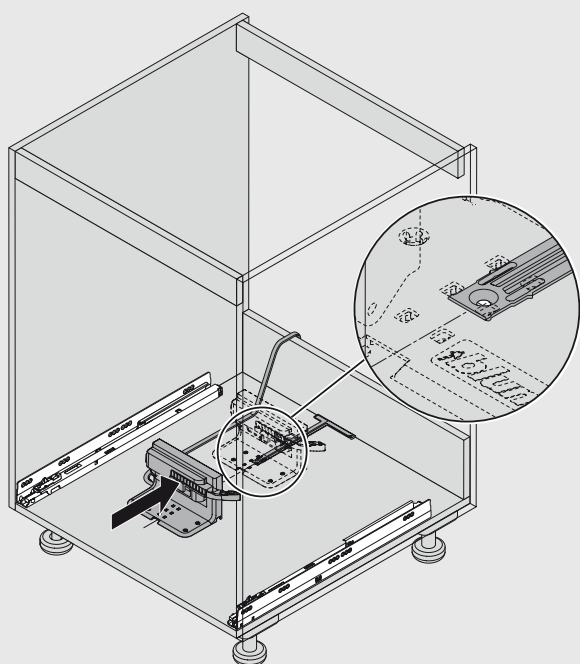

Insert high fronted pull-out

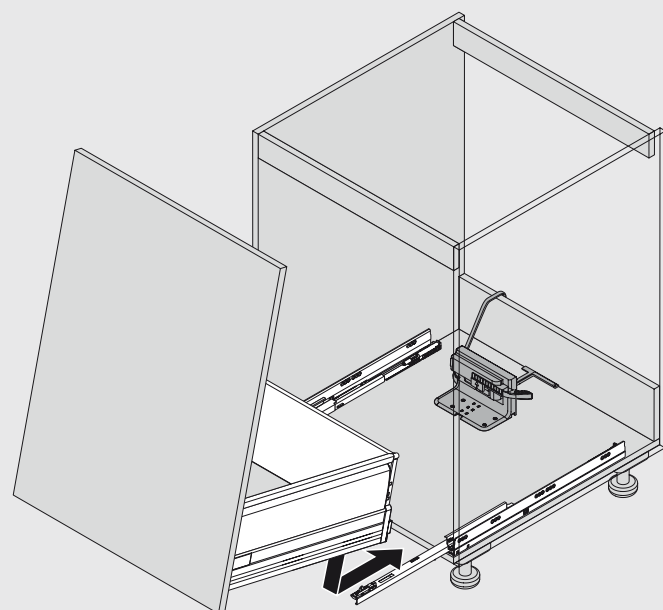

SERVO-DRIVE uno

Assembly

Alternative: Assembly with assembly device

Close high fronted pull-out

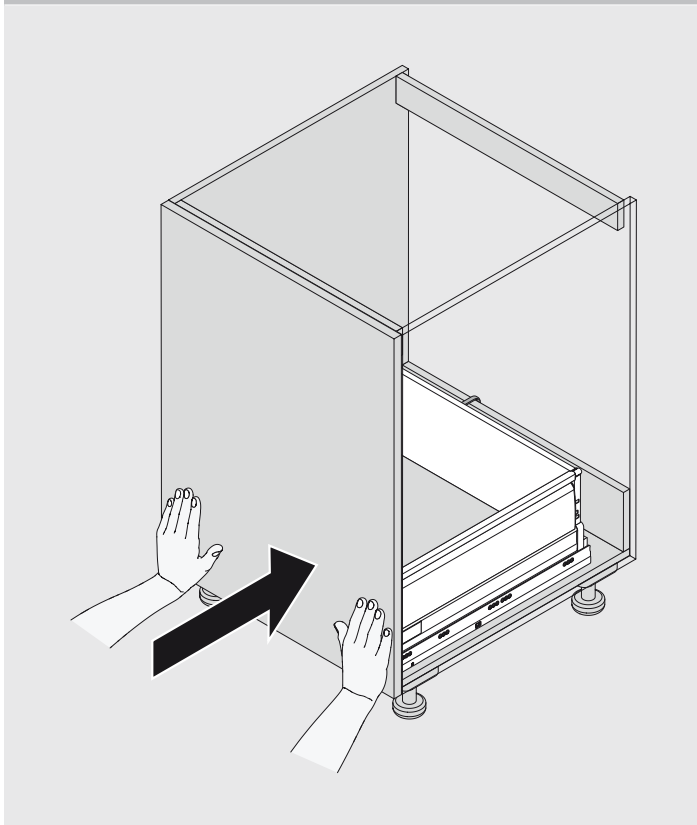

Screw on attachment bracket

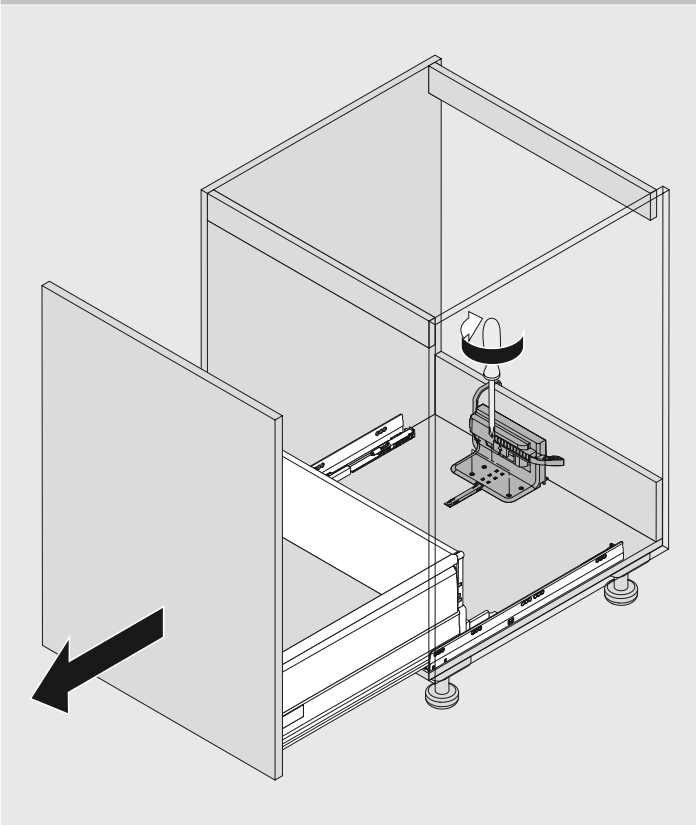

Remove the transportation lock, insert the transformer

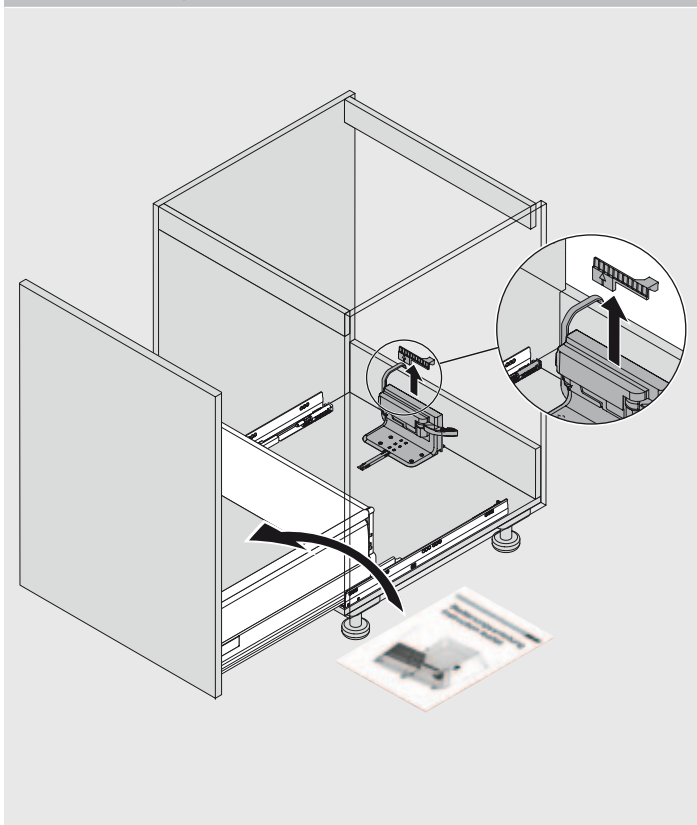

Julius Blum GmbH
Furniture Fittings Mfg.
6973 Hoechst, Austria
Tel.: +43 5578 705-0
Fax: +43 5578 705-44
E-mail: info@blum.com
www.blum.com

